

**THE REAL #1**  
 ANYONE CAN CLAIM IT. WE PROVE IT!



# STINGER

T.R.U. BALL® & AXCEL® PRODUCTS CONTINUE TO BE THE BEST ARCHERY PRODUCTS THAT MONEY CAN BUY. ARCHERS AROUND THE WORLD HAVE PROVEN THESE PRODUCTS BY WINNING GOLD, SILVER, AND BRONZE MEDALS. BY BECOMING THE #1 ARCHERS IN THE WORLD, BY HARVESTING THEIR DREAM TROPHY ANIMALS, OR BY SIMPLY SHOOTING THEIR BEST SCORE AT THEIR LOCAL TOURNAMENTS. THE BEST SHOOTERS IN THE WORLD CHOOSE OUR EQUIPMENT OVER ANY OTHERS! WHETHER YOU'RE ON THE SHOOTING LINE OR IN A TREE STAND, YOU CAN BE CONFIDENT KNOWING THAT YOUR EQUIPMENT IS TRULY THE BEST AND HAS BEEN RIGOROUSLY TESTED IN THE MOST DEMANDING ENVIRONMENTS!

ACHIEVE YOUR BEST WITH T.R.U. BALL® /AXCEL®...  
 THE MAKERS OF PRODUCTS WITH LEADING TECHNOLOGY AND PROVEN RESULTS...

**THE REAL # 1**

# STINGER



**STINGER (TSBR-BK-L)**  
 Buckle / Black / Large

**WARNING:** This product can expose you to chemicals including Nickel Acetate, which is known to the State of California to cause cancer or birth defects or other reproductive harm. For more information, visit [www.P65Warnings.ca.gov](http://www.P65Warnings.ca.gov).



**ACCURACY & ECONOMY  
 BEST OF BOTH  
 WORLDS!**



**STINGER**





# THE #1 SELLING T.R.U. BALL® RELEASE

# STINGER

PULL TRIGGER TO OPEN JAWS.  
LET UP TO CLOSE.

ADJUSTABLE DRAW LENGTH

ADJUST DRAW LENGTH EASILY  
BY CUTTING TUBE AND  
TIGHTENING THE SCREW!

SENSITIVITY ADJUST-  
MENT SCREW

SENSITIVITY ADJUST-  
MENT SCREW

SHOWN IN



### WARNING:

ROD MUST EXTEND ALL THE  
WAY THROUGH THE NUT  
TO INSURE SAFE USE.

ONLY THE BEST!

### T.R.U.-Nok

The ultimate  
metal D-Loop  
for hunting!



### Spyder Speed Silencers

Quiets bows  
while reducing  
vibration!



ORDER YOUR T.R.U. BALL T-SHIRT TODAY  
TRUBALL@TRUBALL.COM • 434-929-2800



www.TRUBALL.com

### CALIPER SENSITIVITY ADJUSTMENT

Sample A

(See Sample A) Hold bow string in one hand and pull release away from you with the other hand when making release sensitivity adjustments. **Never draw bow while setting sensitivity.** To achieve the lightest setting, turn the sensitivity adjustment screw in 1/4 turn increments until it fires prematurely. At this point, back the set screw out 1/16 turn until the release fires prematurely at a pull of around 50 lbs. or greater. Then, back the screw out 1/4 turn (1/2 turn for Assassin Models) and your release will be at its lightest suggested setting. Back the screw out 1/8 turn at a time for a stiffer trigger. Use blue Loc-Tite (#242) if screw is adjusted more than once! Not for use with thinly braided rope loops or rope material under 2mm dia. Call us for quality rope loop made for these release aids!

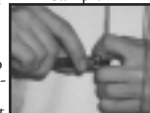

### WARNING:

ALWAYS INSURE RELEASE IS ADJUSTED TO A SAFE SETTING BEFORE DRAWING BOW!  
NEVER DRAW BOW WITHOUT AN ARROW!  
NEVER POINT YOUR BOW IN AN UNSAFE DIRECTION!  
THINK AND ACT SAFELY!

### WARNING:

- \* NEVER DRAW BOW WITHOUT AN ARROW!
- \* ALWAYS POINT BOW AT A SAFE TARGET! NEVER POINT BOW IN AN UNSAFE DIRECTION!
- \* DO NOT LET GO OF THIS RELEASE DURING THE SHOT PROCESS!
- \* ALWAYS KEEP ALL FINGERS BEHIND TRIGGER, WHEN DRAWING BOW, UNTIL READY TO FIRE!
- \* NEVER PULL THE RELEASE TOWARD FACE WHEN DRAWING BOW!
- \* INSPECT EQUIPMENT BEFORE USE TO INSURE PROPER OPERATING CONDITION!
- \* FAILURE TO FOLLOW THESE WARNINGS COULD RESULT IN EQUIPMENT DAMAGE OR INJURY!
- \* THINK AND ACT SAFELY!

### LIMITED WARRANTY

THIS PRODUCT IS GUARANTEED AGAINST DEFECTS IN MATERIAL AND WORKMANSHIP NOT CAUSED BY NORMAL WEAR TO THE ORIGINAL OWNER, WITH A VALID SALES RECEIPT. THIS WARRANTY IS VOID IF THE RELEASE HAS BEEN DISASSEMBLED, ABUSED, MODIFIED, OR SUBJECT TO ABNORMAL CONDITIONS. WRIST STRAPS ARE NOT COVERED UNDER WARRANTY. WE RECOMMEND YEARLY STRAP REPLACEMENT. **LETTING GO OF YOUR RELEASE AID AT ANY TIME DURING THE SHOT PROCESS, AS EVIDENCED BY ABNORMAL DENTS AND/OR BENT PARTS, WILL VOID THIS WARRANTY.**

T.R.U., INC. WILL NOT BE LIABLE FOR ANY CONSEQUENTIAL OR INCIDENTAL DAMAGES TO ANY OTHER PIECE OF EQUIPMENT THE RELEASE MAY COME IN CONTACT WITH. T.R.U., INC. WILL NOT BE LIABLE FOR ANY INJURIES OR DAMAGES TO ANY PERSON, PROPERTY OR EQUIPMENT THAT IS CAUSED BY THE IMPROPER USE OF THIS PRODUCT. IF YOU EXPERIENCE ANY PROBLEM WITH THIS PRODUCT, CALL 434-929-2800 FOR A RETURN AUTHORIZATION (RA) NUMBER, THEN

UPS SHIP TO:  
T.R.U. 131 CRENNEL DR, MADISON HEIGHTS, VA 24572  
OR  
MAIL TO:  
T.R.U. P.O. Box 1180, MADISON HEIGHTS, VA 24572.

ALL RETURNS MUST HAVE A RETURN AUTHORIZATION (RA) NUMBER.

### LEGAL

ITEMS IN THIS PACKAGING MAY BE PATENT PENDING OR COVERED BY US PATENTS & REGISTERED TRADEMARKS. VISIT  
WWW.TRUBALL.COM/LEGAL.HTML  
FOR A FULL LIST OF PATENTS & TRADEMARKS.



ROCK SOLID DEPENDABILITY

THE ALL NEW RHEDTECH FIXED PIN SIGHT FROM AXCEL SIGHTS

MICRO ADJUSTABLE  
WRINGAGE AND ELEVATION KNOBS



SIGHT LIGHT PORT  
(3/8" X 32)

GEAR TOOTH LOCK ENGIN ROTATION  
- ADJUST WHERE YOU WANT IT

AMBIGUITOUS RH AND LH

CHOOSE 4.5 OR 7 FIXED PINS  
OR CHOOSE 0.010" OR 0.019" FIBER PIN SIZES

CHOOSE DIRECT MOUNT (CROWN) WITH OR WITHOUT DAMPER  
OR CHOOSE FED DOVETAIL MOUNT WITH OR WITHOUT DAMPER

TRUE 3RD AXIS ADJUSTMENT



SHOOTER COVER - ADJUST FIBER  
BRIGHTNESS & ELIMINATE STARBURST

AWMING RING AND PINS AT SAME DEPTH FOR ACCURACY

LEVEL VIAL INSIDE SCOPE

AXCEL  
SIGHTS AND SCOPES